

ARGONAUT BOOKS

.....
EVENT PACK





ARGONAUT BOOKS

15-17 LEITH WALK, EDINBURGH, EH6 8LN
INFO@ARGONAUTBOOKS.CO.UK • 0131 259 7816

OPENING HOURS

SUN-THURS 10AM-6PM

FRI-SAT 10AM-8PM

@ ARGONAUTBOOKS ARGONAUT_BOOKS

ARGONAUTBOOKS.CO.UK

DESIGN BY ALEX HARWOOD
ALEXHARWOODDESIGN.COM

CONTENTS

ABOUT US

SHOP INFO

FLOOR PLANS

- Standard
- Book Launch
- Blank Plan
- Discussion
- Games Night

AUTHOR CARE

COSTS

CUTOUTS



ABOUT US

Tucked inside the old Leith Central Train Station at the foot of Leith Walk, Argonaut Books is a light and airy community bookshop and café. We are staffed by a team of highly experienced booksellers who have previously worked in Waterstones, Blackwells, many independent bookshops, as well as the Edinburgh International Book Festival, independent and Big 5 publishing, board game design, marketing, editing, copywriting, and events management.

Catering to a local population of over 50,000 in Scotland's most densely populated neighbourhood, we hold a varied and exciting stock of new releases, old favourites, and choice backlist, resulting in an overall selection you will not find anywhere else.

We have a highly engaged and interested community around our shop, and our book launches, reading groups, and evening events are regular sell-outs. Please read on for more information about our space, and why we think we're perfect for you and your event.

AT A GLANCE



ACCESSIBILITY

Ground level; fully accessible to all mobility needs; gender- neutral toilets; shop well-served by public transport.



HOSPITALITY

Coffee machine, selection of **local beers and wine**, **speciality tea** by PekoeTea, **artisan baking** by Crema Bakehouse.



BRANDING

We are also able to provide **bespoke marketing material** in line with our house style to market events or tie in with existing branding.

LAYOUT

Fully modular, customisable shop layout thanks to bespoke shelving and counter by Sylvan Studio.



CAPACITY

Up to 50 in-store capacity, with priority relationships with larger local venues for larger scale events.



HIRE COST

Scaled to means, and free to hire for community groups.

STANDARD

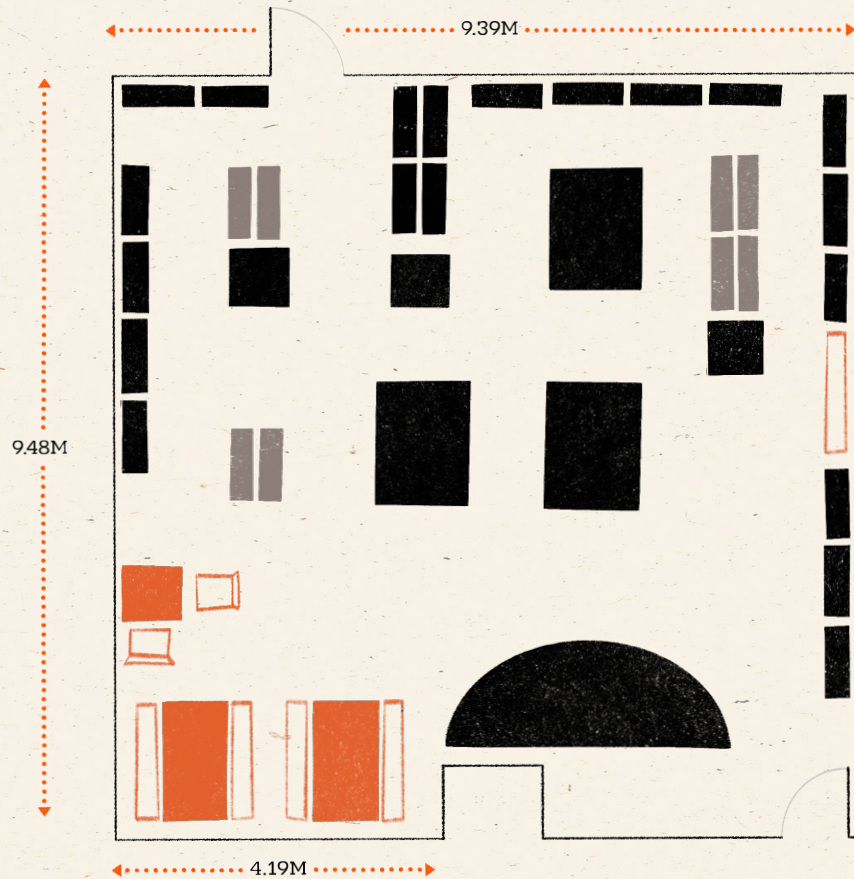

The day-to-day shop layout (for legend, refer to the cutouts page). Our space is modular, and can be arranged however best suits your event. Make your own layout using our cutouts and blank template!

Stage area, flexible audience seating up to a capacity of 40, and space for signed books and refreshments behind audience.

PA system available, and author green room area and private bathroom located in rear of shop.

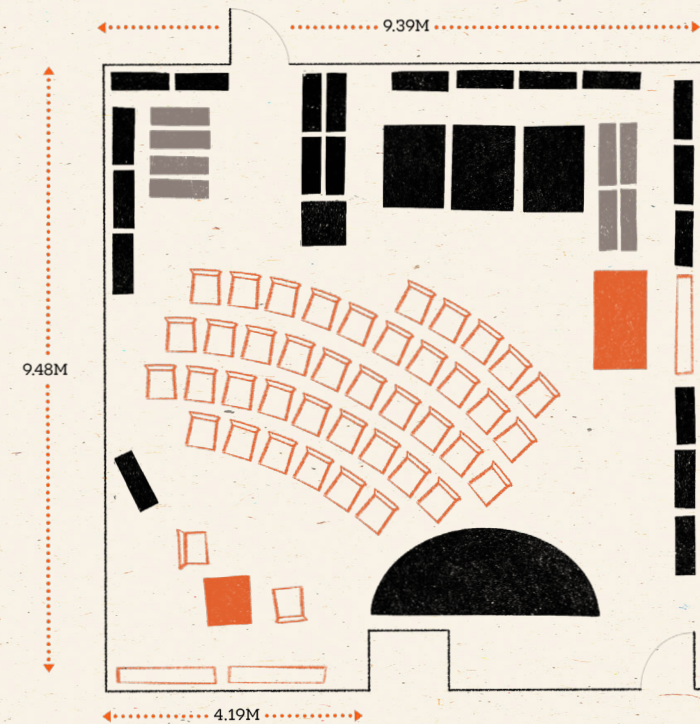

BOOK LAUNCH

MAKE YOUR OWN

Use the cutouts on the last page or sketch directly onto this template to find your perfect layout.

9.48M

9.39M

4.19M

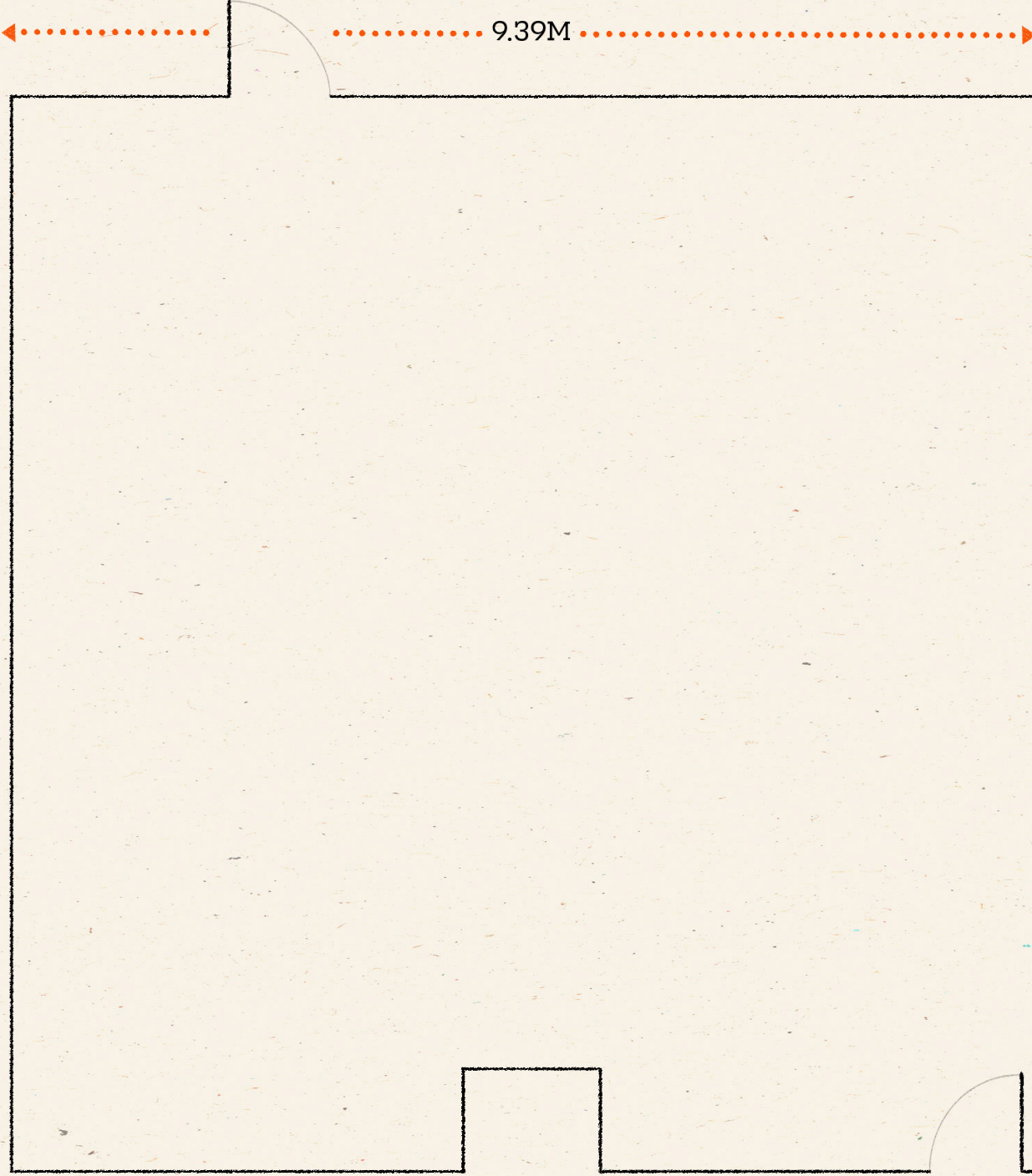

GAMES NIGHT

The space is configurable, whether it's a multiple conversations or a single roundtable discussion.

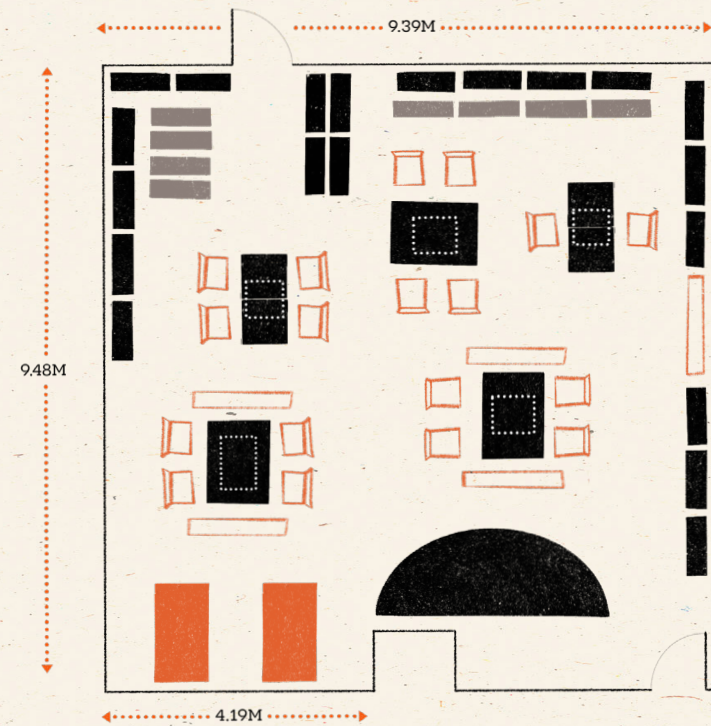
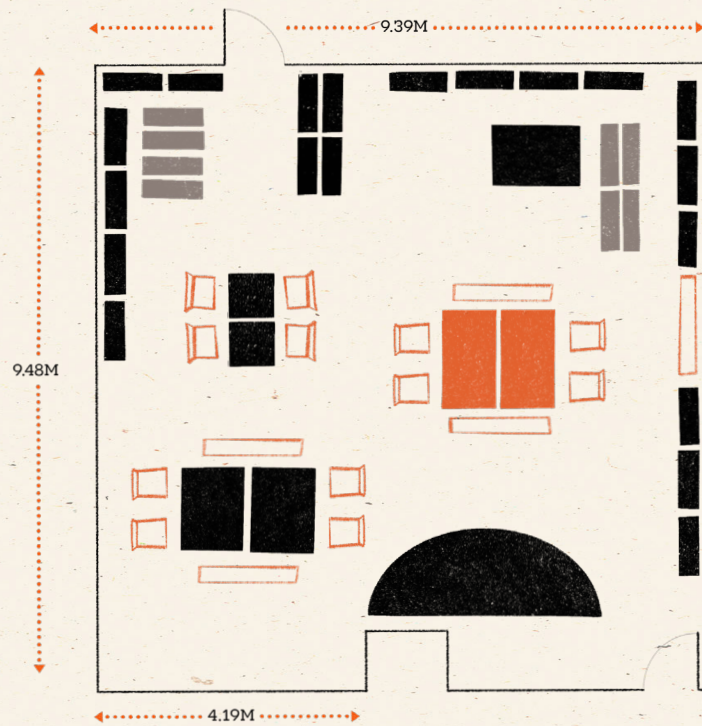

The layout can be altered to suit whichever games are being played. Large RPG adventures fit perfectly next to head-to-head strategic showdowns.

DISCUSSION

AUTHOR CARE

.....

Alongside giving our audiences an excellent experience, our highest priority is creating a comfortable and relaxed atmosphere for our guest authors. After many years in the book event industry we understand how important it is to make sure that every part of the process runs as smoothly as possible.

To this end, we have the ability to facilitate every part of the process in-house signing pens to audio equipment. We are also lucky to belong to a thriving community of independent businesses in Leith, all of whom rely on the others to make our neighbourhood the destination it is today. We are happy to offer discounts with many of these businesses to anyone who books with us.

We are a shop run by Leith locals and will happily offer recommendations and pointers for our favourite things - old and new - in the area if you're visiting from out of town.



MICS & PA



GREEN ROOM



BATHROOM



REFRESHMENTS



LOCAL AMENITIES

We have also partnered with our neighbours to provide discounts with many local businesses. These include:

- Artisan Roast
- Crema Bakehouse
- PekoeTea
- Logan Malloch
- Leith Bottle Shop
- Seb's Urban Jungle
- Faceplant Foods
- Smoke & Mirrors
- Lioness of Leith

CUTOUTS

Cut out these shapes and arrange them on the blank template to find the perfect layout for your event.

Large book tables x 3

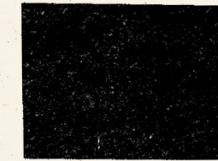

Coffee tables x 2



Small tables x 4

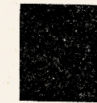

CHAIRS

We can provide up to **40 foldable chairs** for your event, arranged however you need.

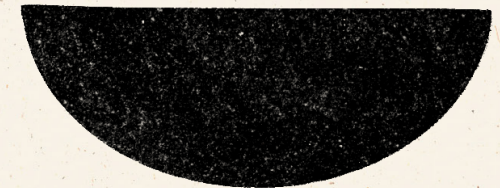
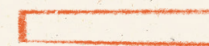

Till block

Full-height bookshelves x 23

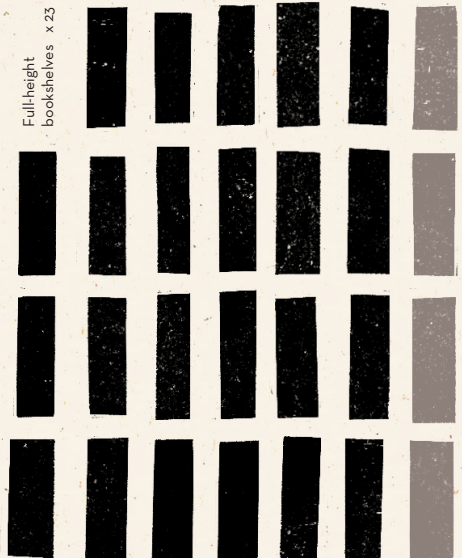

Half-height bookshelves x 4

Benches x 5

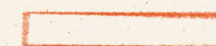
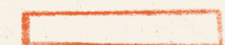
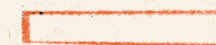

COSTS

Our prices are negotiable, and fees to rent our space are scaled to means. Whatever the nature or size of the event, we accommodate clients from a wide array of industries and backgrounds to provide fair and flexible costs.

Depending on the client, and size/type of event, a **20% deposit** may be applicable. In most cases, our space is **free to rent for community groups**.

We require **3 weeks advance notice** for bookings.

